

Fully automatic stool analysis

# SENTiFIT<sup>®</sup> 800 Analyser

Dedicated high-throughput  
platform for faecal  
immunochemical testing



# Versatile and high-performing

*For decades, Sysmex has been driving innovation in the field of diagnostic solutions – from point-of-care to total lab automation system.*

The SENTIFIT 800 Analyser, alongside the faecal immunochemical tests (FIT), is a non-invasive diagnostic for the detection of faecal occult blood (FOB) and is an effective triage for physicians when determining if patient will benefit from further invasive investigation.

With CALiaGold, we offer a second automated test for faecal calprotectin measurement. This is a specific diagnostic and activity marker for inflammatory diseases in the intestine. Laboratory testing works very well as a first indication of bowel inflammation as well as for follow-up testing to monitor treatment success. Both tests are designed for fast, highly automated and safe processing of stool samples.

## Patented 2-in-1 collection tubes made in Europe

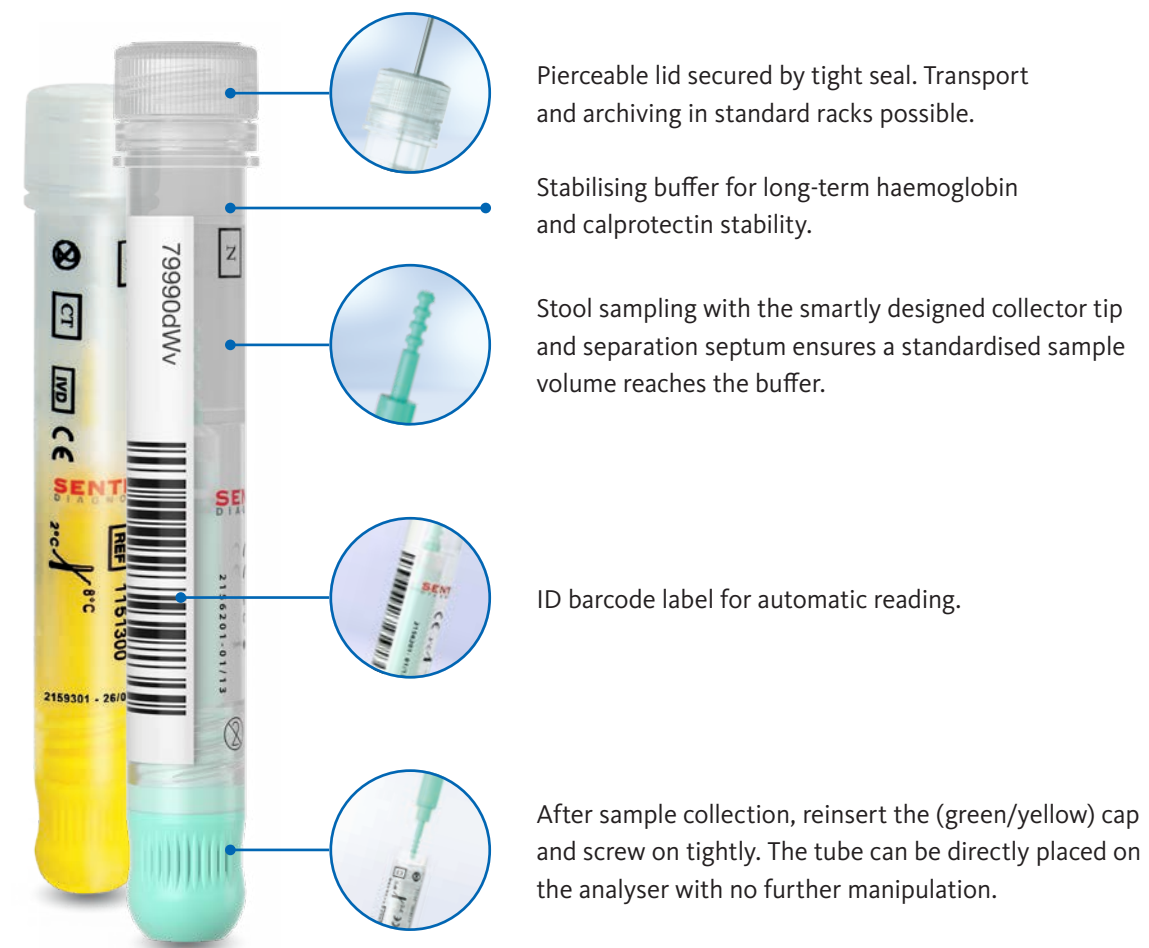

More information about SENTIFIT 800 Analyser is available at [www.sysmex-europe.com/sentifit800](http://www.sysmex-europe.com/sentifit800)



Scan the QR code to place and see the virtual 3D instrument in your lab.

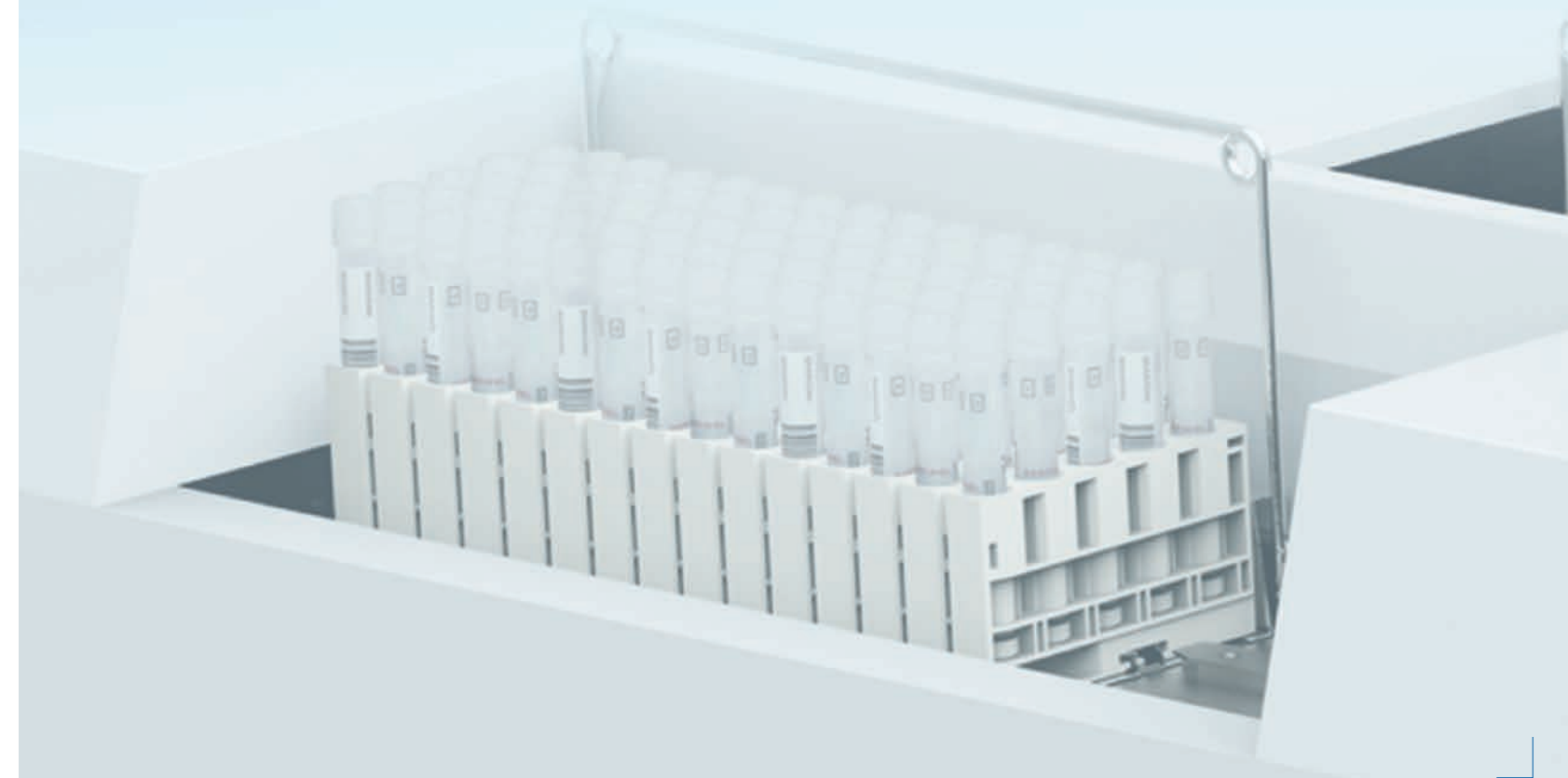



## Your benefits at a glance

### Reduced hands-on time thanks to high automation

- ✓ No sample preparation needed
- ✓ Automatic lid-piercing function
- ✓ Automatic dilution if analyte concentration is elevated
- ✓ Direct connection to the water supply and drainage

### Time-saving from easy handling

- ✓ Stable refrigeration of reagents on-board for long periods
- ✓ Barcode reading for full traceability of all samples and reagents
- ✓ Double-feeding module for continuous loading while measuring
- ✓ Parallel measurement of different assays

## Selected specifications

|   |   |
|---|---|
| <b>Technology</b>                             | Clinical-chemical analyser for quantitative immunoturbidimetric identification of various antigens in stool samples |
| <b>Throughput</b>                             | Up to 550 samples/hour  |
| <b>Dimensions/weight</b><br>W × H × D [mm/kg] | 1300 × 1150 × 850/300   |

**Ref: 550802**    **SENTiFIT® 800 Analyser**  
High throughput system for faecal immunochemical testing

**Ref: 550801**    **Rack Handler RH-150**  
Automatic sample rack loader for SENTiFIT 800

SENTiFIT® is a trademark in various jurisdictions, which is exclusively licensed to SENTINEL CH. SpA.

**Distributor EMEA: Sysmex Europe SE**  
Bornbarch 1, 22848 Norderstedt, Germany · Phone +49 40 52726-0 · Fax +49 40 52726-100 · lifescience@sysmex-europe.com · [www.sysmex-europe.com](http://www.sysmex-europe.com)

**Manufacturer: SENTINEL CH. SpA**  
Via Robert Koch 2, 20152 Milan, Italy

You will find your local Sysmex representative's address under [www.sysmex-europe.com/contacts](http://www.sysmex-europe.com/contacts)